

SITE PLANNING GUIDE



CT1

BrightSpeed Elite 16

GE BrightSpeed Elite 16

Mobile unit CT1

ED EURO
DIAGNOSTIC

Eurodiagnostic sp. z o.o.

ul. Kielecka 41A/8

02-530 Warszawa

Poland

Tax number: EU5252386042

KRS: 0000829936

This site planning guide shortly presents the mobile unit and describes preparations needed to be made by the client, in order to receive and connect the mobile unit.



CT1

GE BrightSpeed Elite 16

Mobile unit CT1



BASIC DATA

System ID:	CT1
Manufacturer:	General Electric
Model:	BrightSpeed Elite 16
Year of production:	2011
Tube YOM:	2018
No. of slices:	16
Software:	13BW29.5
Gantry opening:	60cm
Max table load:	205kg
Options:	Smart Prep Smart Speed Helical Tilt AutoMA Power440 Patient-16-slice 3000 Image Series Direct-3D 90kVA CopyComposer Thin Twin Helical Direct-MPR Data Export Connect Pro Volume Viewer EnhancedRecon ASIR Real Time CT Fluoro Enhanced Xstream Injector

CT1

GE BrightSpeed Elite 16

Mobile unit CT1



TRAILER DETAILS

Type	CALUMET
Length	13.58m
Width	2.46m (4.78m unfolded)
Height	3.95m
Weight	30 200kg
Min. area for placement	15.50m x 6.50m

UNIT FEATURES

Air-conditioning in all rooms	YES
Storage cabinets	YES
Sound system and FM tuner	YES
Hydraulic patient lift	YES
Sink with running water	YES
IT/Network connections in operator room	YES
Changing room for the patient	YES

ADDITIONAL FEATURES

Injector	Medrad Stellant - dualhead
Reference clinic workstation	YES
CD/DVD burner	YES
RIS/PACS Network connection	YES

CT1

GROUND SURFACE

level (no more than 2% (1.15 degree) tilt and solid surface with a loading capacity of 30 200kg. Additional reinforcements are required on unstable ground. This could occur with concrete, road surfacing or pavement (bound material) for example.

Support pad a full pad measuring 13.58m x 4.78m located as shown on the diagram below. The support pad must be level (no more than 150mm variations over length and 50mm variation across length) to insure proper handling of the mobile system.

Service pad a full pad measuring 15.50m x 6.50m located as shown on the diagram below, is recommended to provide service access.

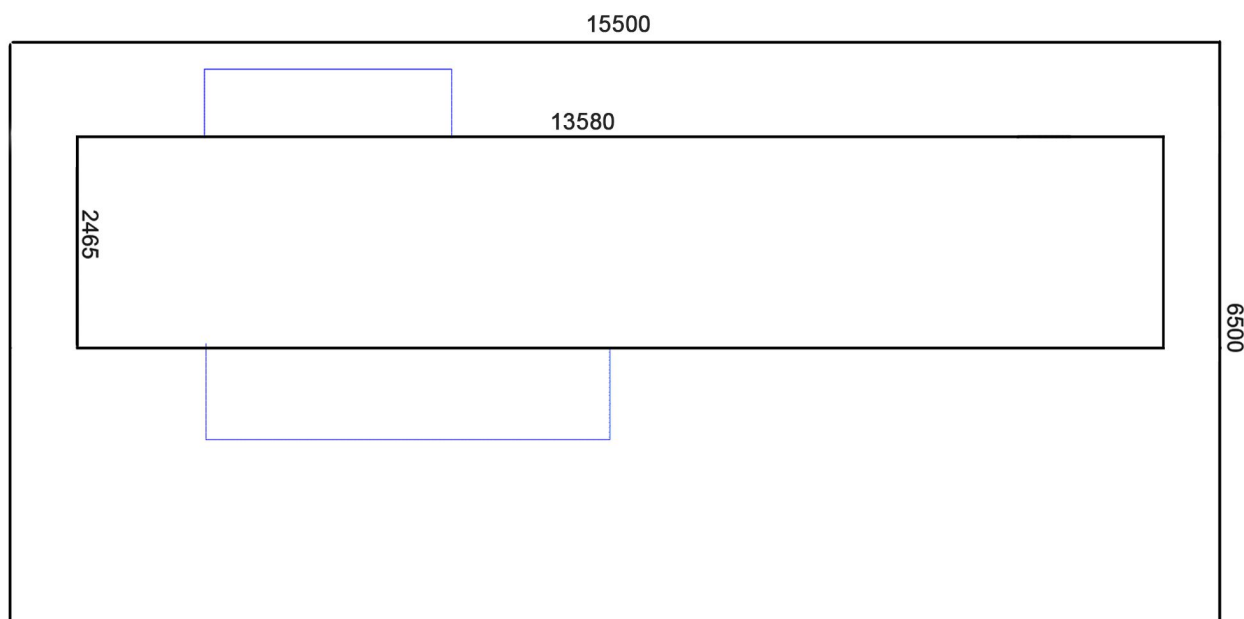

If you have any doubts regarding the placement and access, please contact Eurodiagnostic engineer.

ACCESS ROUTE

The entrance to the location must be passable, curb free and clear of parked cars: this is for both delivery and collection. The access way must have a minimum width of 7.2m. The radius of the turning circle should have an external radius of 12.5m and an internal radius of 5.3m. An engineer from Eurodiagnostic can be consulted on placement and access. Please look at the illustration below that details the turning circle needed for the trailer.

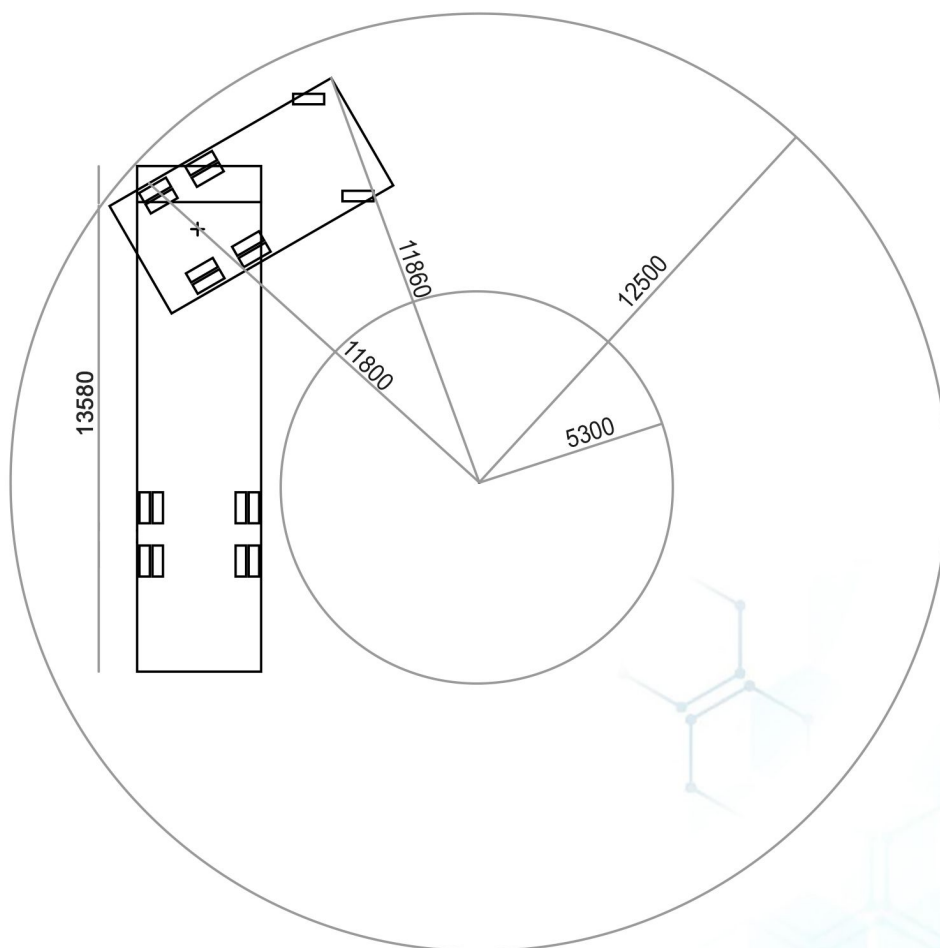

MOBILE UNIT LAYOUT

The mobile unit can be accessed, via a staircase (90cm) and patient lift, both located on the front right side of the unit. The back end is also equipped with a door, but this is only for service purposes. The patient lift can be used, to enable patient trolley access. The patient lift has a dimension of 210 x 165cm and a max capacity of 450kg.

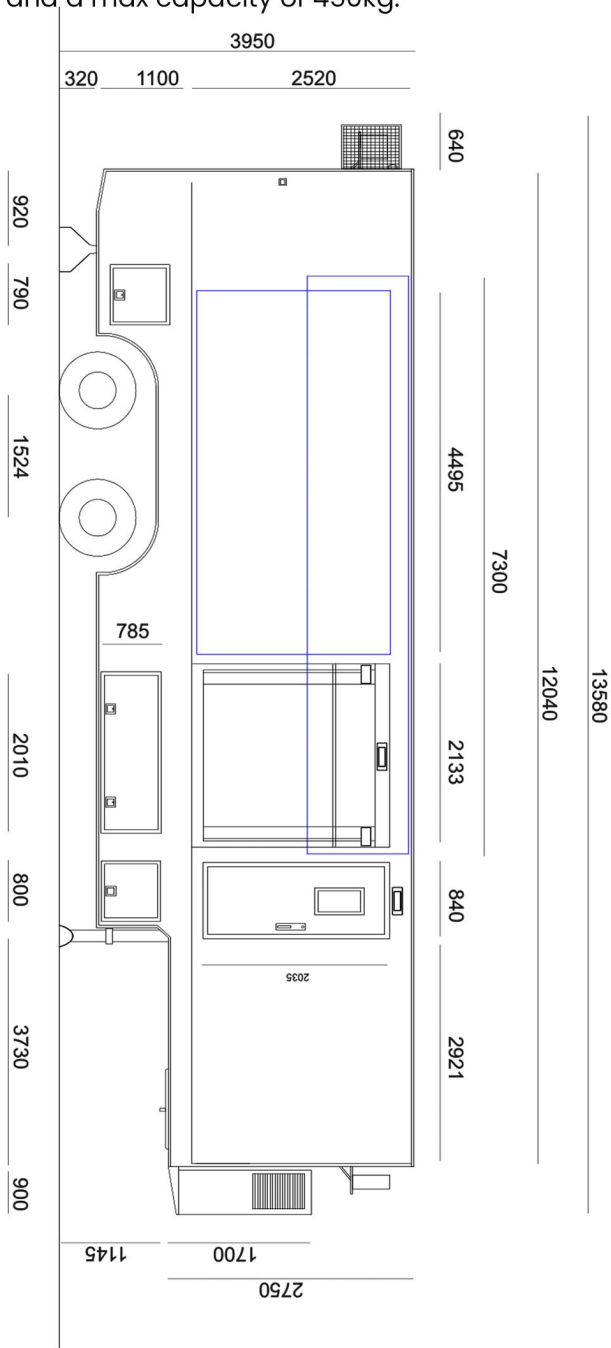

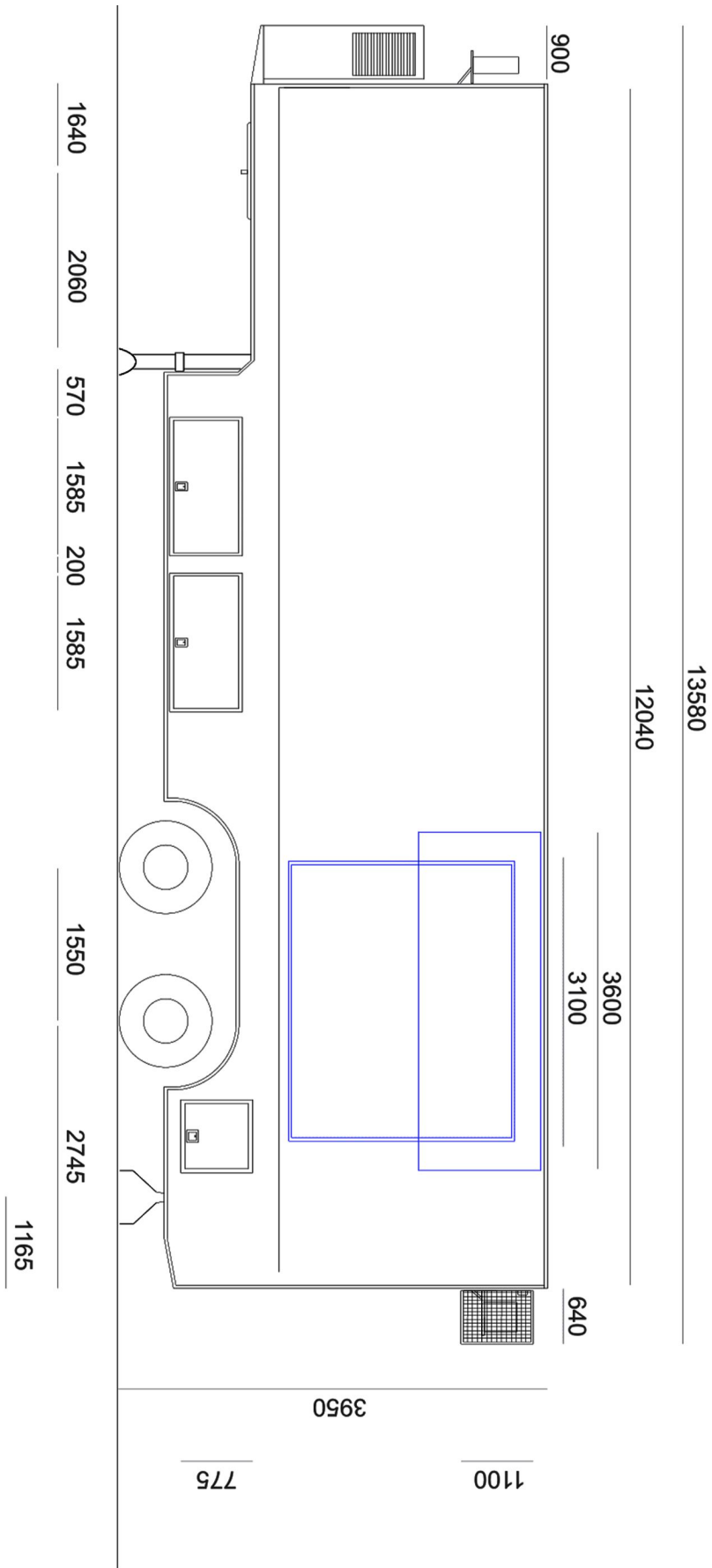

GE BrightSpeed Elite 16

Mobile unit CT1

ED EURO
DIAGNOSTIC

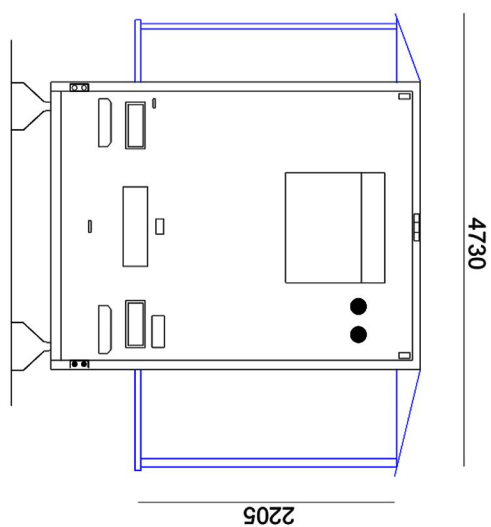
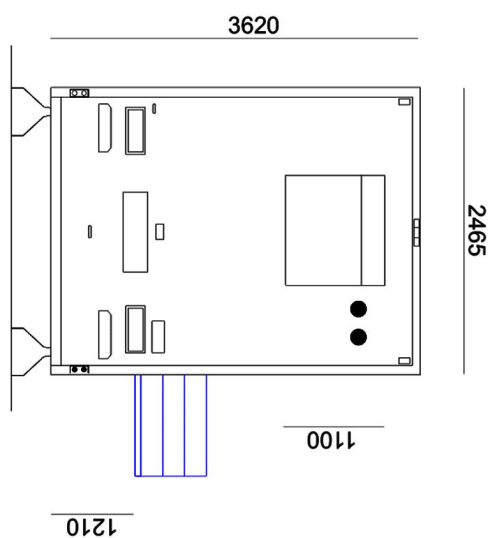
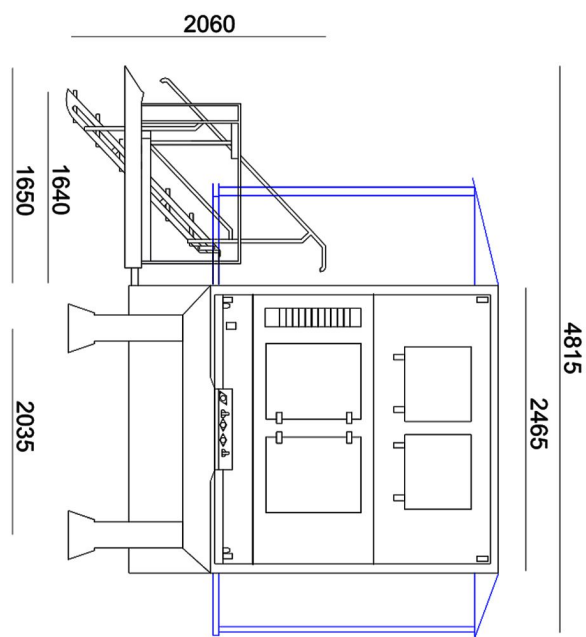

CT1

GE BrightSpeed Elite 16

Mobile unit CT1

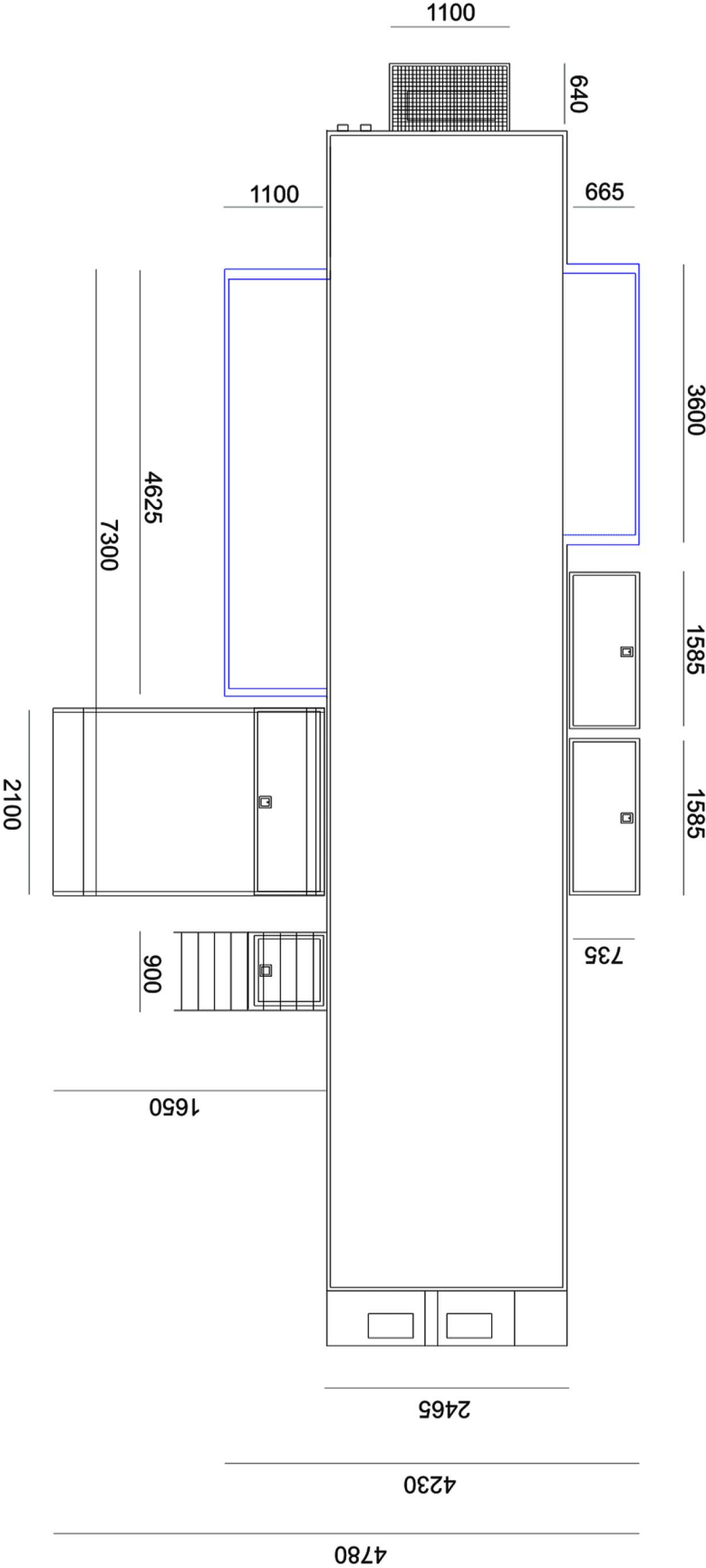

CT1

GE BrightSpeed Elite 16

Mobile unit CT1

ED EURO
DIAGNOSTIC

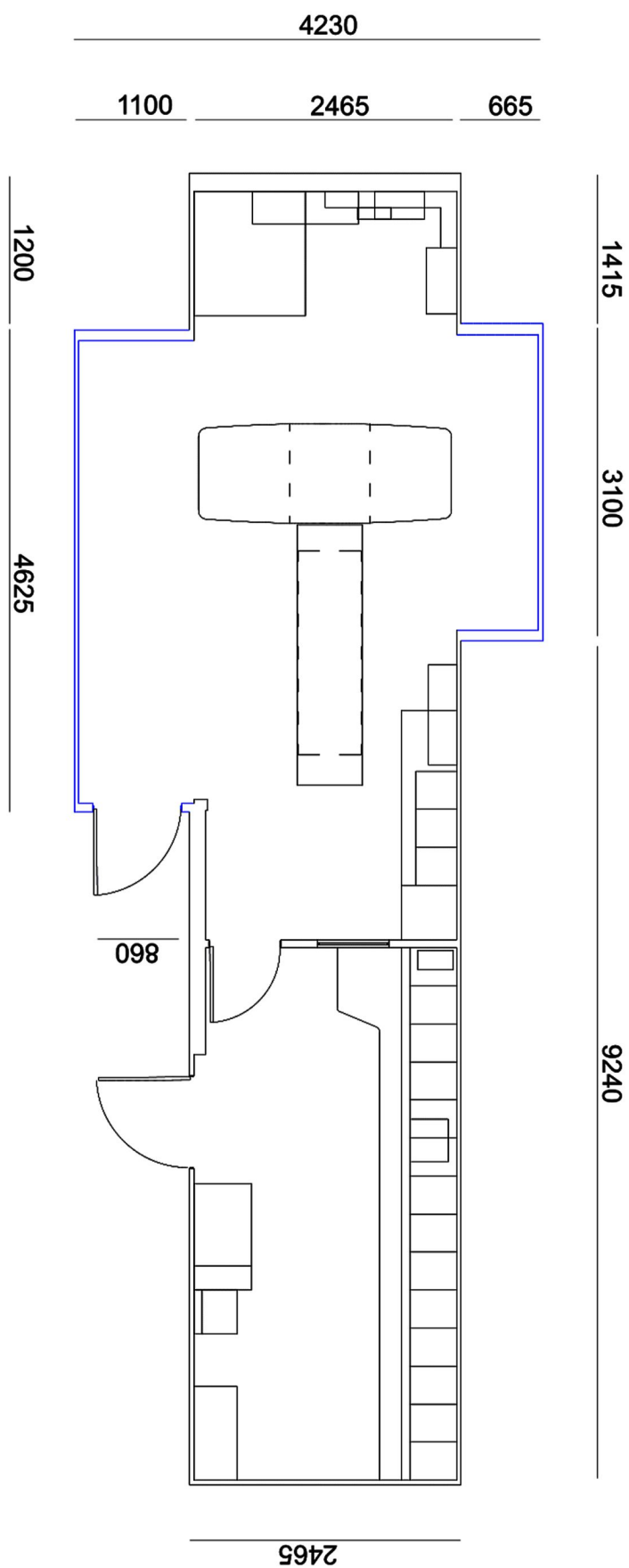

CT1

PHONE AND NETWORK

The mobile unit is equipped with data lines (RJ45 sockets). Socket/switch is available, in the operator room, for auxiliary communication equipment such as computers, laptops or IP telephones.

The RJ45 plugs found inside the trailer must be connected to the hospitals network, via the RJ45 connectors/sockets found on the outside of the trailer (belly compartment). The connection of computers, phones and other communication equipment is the client's responsibility.

POWER REQUIREMENTS

Power cable length	15 – 20m
Type of socket required for power supply	Fixed socket 5P 125A 400V IP67
Maximum power parameters	120kW
External connection protection	160A
Cable length up to 50m	5 x 35mm ² (copper cable) 5 x 65mm ² (aluminium cable)

The customer is responsible for bringing the appropriate cable to the electrical box. Cable cross-section up to 50 linear meters: 5 x 35mm² (copper cable) or 5 x 65mm² (aluminum cable) above 50 linear meters, the cable cross-section should be increased.

POWER BOX



SOCKET

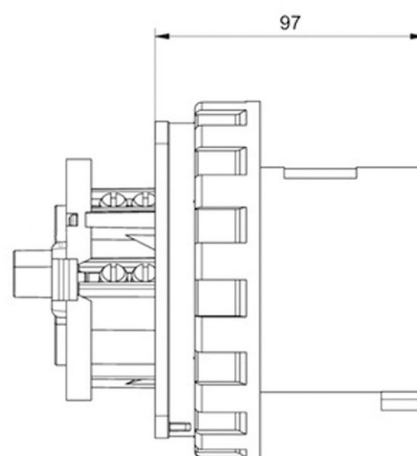
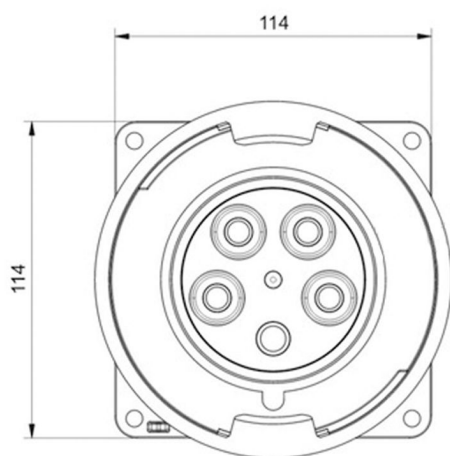

GE BrightSpeed Elite 16

Mobile unit CT1



SERVICE

Maintenance and full service contract of mobile unit included.

The client is responsible for all necessary preparations of the installation location, the access route as well as the provisions of the required connections.

The client is also responsible for possible approval procedures.

For technical questions, please contact:

Radosław Borkowski,

mobile: +48 692 428 731

email: rborkowski@eurodiagnostic.pl

CT1